

39-303X-COAP6300-KIT

Mounting Bracket to install Cisco ESW 6300 APs inside Oberon's NetPoint™ model 3030 and 3032 Wi-Fi Bollards

Collection: Accessories | **Series:**

This is an accessory to mount the Cisco ESW 6300 series outdoor APs inside the Oberon's NetPoint™ Model 3030 and 3032 Wi-Fi bollards. This zinc plated bracket attaches to the interior fiberglass equipment stand, and the AP is attached to the bracket.

Features & Benefits

- Secure and conceal Cisco ESW 6300 Access point, connected antennas, and cabling in public environments
- Mount AP and antennas at desired height inside the Bollard

Technical Specifications

- Construction: Zinc plated steel
- Includes bracket and hardware for mounting the bracket on the interior fiberglass equipment stand
- Size: 12.5 X 5.7 X 2 in.
- Made in the USA

Fits the following AP's:

Cisco
C-ANT9101 antenna

Have questions about any of our solutions?

Contact us at 877-867-2312 or Sales@oberoninc.com

Shown with hardware

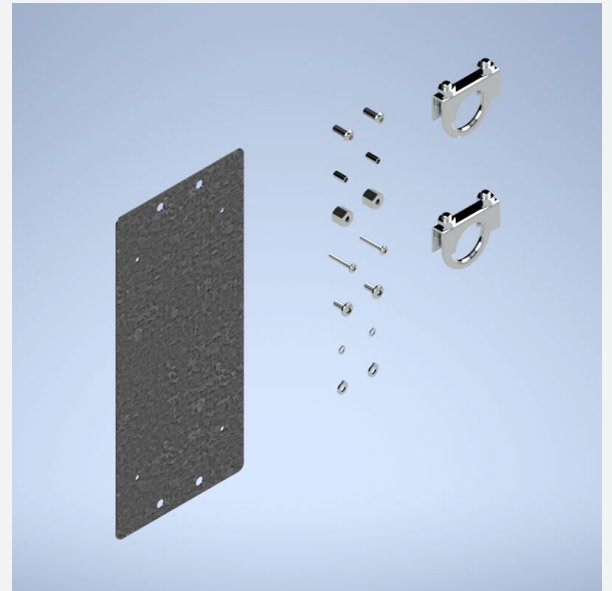

Measurements (Maximum values*):

Width: 12.5 in.
Back-box: xx in.
Height: 5.7 in. Depth: 2 in.
Item Weight: 1 lbs.
Shipping Weight: 1 lbs.