

1039-CCOAP3800

Recessed Tile Ceiling Installation Kit for Wi-Fi Access Points
/ Cisco 2800, 3800 Trim

Collection: In-Plane™ | Series: 1039

Suspended ceiling mounting kit for most vendors' Wi-Fi APs. A cutout is made in the ceiling tile, the tile bridge is placed above the ceiling tile, and the AP is attached to the white trim. The AP and trim assembly is then drawn into the tile bridge with a wing nut, with only the front face of the AP exposed for optimal wireless coverage. Trim is easily swapped out for new APs without tools.

Accessories

- [88-104X-ROUTER-TEMPLATE](#) - Route Opening Template for 1040 and 1044 series AP mounts



Features & Benefits

- Economical and easy to install
- Conveniently and quickly install APs and antennas from most vendors into 24 in. wide suspended ceiling tiles
- AP mounts flush to the ceiling, providing an aesthetic, professionally installed appearance
- 16 ga. galvanized steel tile bridge and support wire prevent ceiling tile sag or cracking

Technical Specifications

- Design: Recessed installation kit for installing Wi-Fi APs in 24 in. wide suspended ceiling tiles. Comprised of steel ceiling tile bridge, support wire, AP bracket, and trim for AP from leading vendors
- Performance: Designed to meet NEC300-22 and 300-23 for plenum installations
- Wi-Fi AP trim is interchangeable for other leading APs. Trim attaches with wing nuts
- Construction: 16 ga. galvanized steel tile bridge, all metal bracket and trim
- Use included support wire to attach to building structure
- Size: 23.375 x 3 x 3 in. (594 x 76 x 76mm)
- Suitable for both North American and European (metric) sized ceilings
- Made in the USA

Safety & Standards

- CSA C22.2 NO. 60950-1-07 + Amd. 1 Amd. 2 Information Technology Equipment – Safety. Part 1, General Requirements

Fits the following AP's:

Cisco
2800e/3800e Series, 2800i/3800i Series

Have questions about any of our solutions?

Contact us at **877-867-2312** or
Sales@oberoninc.com

Shown with AP (not included)

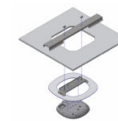

Measurements (Maximum values*):

Width: 23.375 in.
Back-box: xx in.
Height: 3 in. Depth: 3 in.
Item Weight: 4 lbs.
Shipping Weight: 5 lbs.

Includes:

- (1) Galvanized steel ceiling tile bridge
- (1) AP specific bracket and trim
- (2) Grid Wires
- Required Hardware
- Installation instructions

